



Description Rotary switch disconnector

Code MSS 630

No. of poles 3P

Rated current 630 A

ELECTRICAL CHARACTERISTICS

Standard	EN 60947-3
AC Rated operational voltage (Ue)	400 V
DC Rated operational voltage (Ue)	220 V
AC Maximum operational voltage (Ue max)	690 V
DC Maximum operational voltage (Ue max)	500 V
Rated insulation voltage (Ui)	1000 V
Rated impulse withstand voltage (Uimp)	12 kV
Rated short-time withstand current for 1s (Icw)	13 kA
Rated short-circuit current making capacity (Icm)	45 kA
Conditional short-circuit current with fuse (Icc)	70 kA (gG 630 A)
Power dissipation per pole	30,9 W

MECHANICAL CHARACTERISTICS

Mechanical life	5.000 cycles
Maximum number of auxiliary contacts that can be installed	1
Minimum cable size	2x150 mm ²
Maximum cable size (rigid/flexible)	2x300 mm ²
Maximum busbar width	50 mm
Rated tightening torque	20 Nm
Pre-arrangement for lock in OFF position	Yes (ø8 mm max)
Height	170 mm
Width (mm)	230
Depth	110 mm
Weight (kg)	4

AC RATED OPERATIONAL CURRENT (Ie)

AC-20A / AC-20B (690V AC)	630 A / 630 A
AC-21A / AC-21B (400V AC)	630 A / 630 A
AC-21A / AC-21B (500V AC)	630 A / 630 A
AC-21A / AC-21B (690V AC)	500 A / 500 A
AC-22A / AC-22B (400V AC)	630 A / 630 A
AC-22A / AC-22B (500V AC)	500 A / 500 A
AC-22A / AC-22B (690V AC)	315 A / 315 A
AC-23A / AC-23B (400V AC)	500 A / 500 A
AC-23A / AC-23B (500V AC)	315 A / 315 A
AC-23A / AC-23B (690V AC)	160 A / 200 A

DC RATED OPERATIONAL CURRENT (Ie)

DC-20A / DC-20B (220V DC)	630 A / 630 A
DC-20A / DC-20B (400V DC)	630 A / 630 A
DC-20A / DC-20B (440V DC)	-
DC-20A / DC-20B (500V DC)	630 A / 630 A
DC-21A / DC-21B (220V DC)	630 A / 630 A
DC-21A / DC-21B (400V DC)	500 A / 500 A (2 poles in series for "+" and 1 pole for "-")
DC-21A / DC-21B (440V DC)	-
DC-21A / DC-21B (500V DC)	500 A / 500 A (2 poles in series for "+" and 1 pole for "-")
DC-22A / DC-22B (220V DC)	500 A / 500 A
DC-22A / DC-22B (400V DC)	500 A / 500 A (2 poles in series for "+" and 1 pole for "-")
DC-22A / DC-22B (440V DC)	-
DC-22A / DC-22B (500V DC)	-
DC-23A / DC-23B (220V DC)	500 A / 500 A
DC-23A / DC-23B (400V DC)	-
DC-23A / DC-23B (440V DC)	-
DC-23A / DC-23B (500V DC)	-

DIMENSIONAL

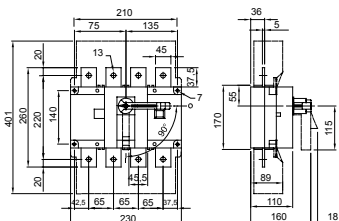



Product Data Sheet

GW97732

97 MSS Range

STANDARDS/APPROVALS



GEWISS S.p.A. Via A. Volta, 1
24069 Cenate Sotto - Bergamo - Italy
tel. +39 035 94 61 11 fax +39 035 94 69 09
Company subject to the management and
coordination of Polifin S.p.A.

www.gewiss.com
sat@gewiss.com
Last update 10/03/2026

Data, measures, designs and pictures are shown
only as informative purposes,
and could be changed without previous notice