

PCD7.T161 and PCD7.T162

Generality

The RS-485 Standard requests that the bus must be terminated. The end resistor is fixed at 120 Ω, which is the same as the default value of the PCD7.T160. An electrically isolated supply provides bias voltage at the necessary off-load potential for signal lines D and /D.



Technical data

- 17.5 mm case (same as ALD)
- 230 VAC +15 % / -20 % for PCD7.T161
- 24 VAC / DC -15 % / +15 % for PCD7.T162
- Power consumption of 0,4 W
- Isolated supply
- Fixed end resistor of 120 Ω
- Power-on LED

Wiring diagram

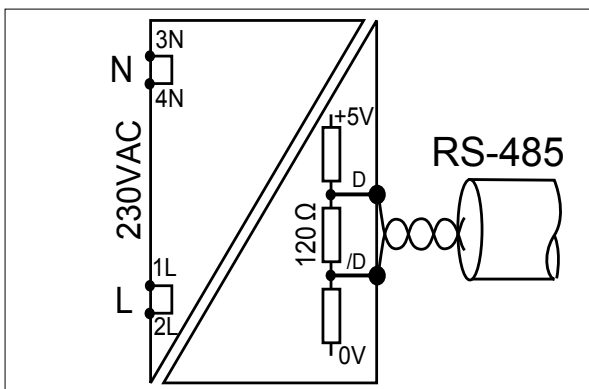

PCD7.T161 230 VAC 50 Hz

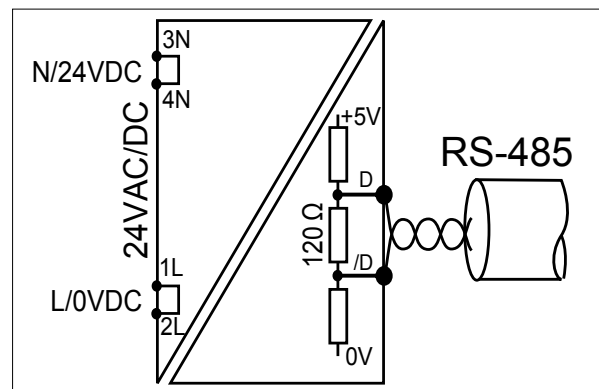

PCD7.T162 24 VAC/DC 50 Hz

Characteristics:

	PCD7.T161	PCD7.T162	Remarks
Power Supply	230 VAC	24 VAC / DC	
Case	17.5 × 85 × 64 mm	17.5 × 85 × 64 mm	PCD7.T161 and PCD7.T162 are in accordance with the standard of electric cabinet
End resistor	Fixe 120 Ω	Fixe 120 Ω	
Indication	LED for 230 VAC	LED for 24 VAC / DC	

Connection example

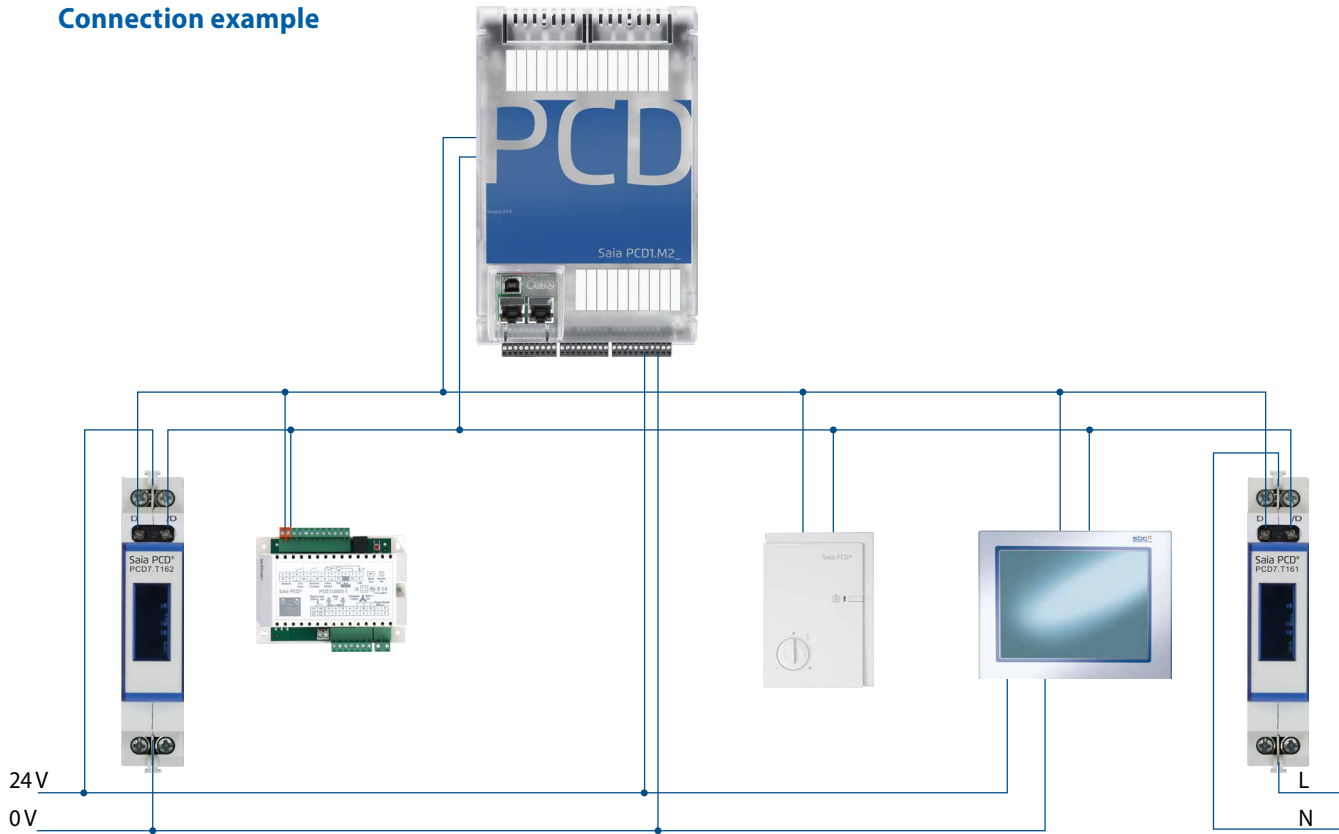

More details about the connection of RS-485 bus can be read in documents PP26-215, 26-739 and 26-740.

Guarantee

PCD7.T161 and PCD7.T162 are guaranteed for a period of 24 months from the production date.

Ordering information

Type	Description	Weight
PCD7.T161	Termination box, RS-485 line, electrically isolated, 230 VAC	80 g
PCD7.T162	Termination box, RS-485 line, electrically isolated, 24 VAC/DC	80 g

Saia-Burgess Controls AG

Bahnhofstrasse 18 | 3280 Murten, Schweiz
T +41 26 680 30 00 | F +41 26 580 34 99
www.saia-pcd.com

support@saia-pcd.com | www.sbc-support.com