



Description Rotary switch disconnecter

Code MSS 125

No. of poles 4P

Rated current 100 A

#### ELECTRICAL CHARACTERISTICS

Standard	EN 60947-3
AC Rated operational voltage (Ue)	400V
DC Rated operational voltage (Ue)	220 V
AC Maximum operational voltage (Ue max)	690 V
DC Maximum operational voltage (Ue max)	440 V
Rated insulation voltage (Ui)	800 V
Rated impulse withstand voltage (Uimp)	8 kV
Rated short-time withstand current for 1s (Icw)	2,5 kA
Rated short-circuit current making capacity (Icm)	12 kA
Conditional short-circuit current with fuse (Icc)	100 kA (gG 100A)
Power dissipation per pole	3,1 W
<b>AC RATED OPERATIONAL CURRENT (Ie)</b>	
AC-20A / AC-20B (690V AC)	100 A / 100 A
AC-21A / AC-21B (400V AC)	100 A / 100 A
AC-21A / AC-21B (500V AC)	100 A / 100 A
AC-21A / AC-21B (690V AC)	80 A / 80 A
AC-22A / AC-22B (400V AC)	100 A / 100 A
AC-22A / AC-22B (500V AC)	100 A / 100 A
AC-22A / AC-22B (690V AC)	40 A / 40 A
AC-23A / AC-23B (400V AC)	63 A / 63 A
AC-23A / AC-23B (500V AC)	50 A / 50 A
AC-23A / AC-23B (690V AC)	25 A / 25 A
-	-
-	-
-	-
-	-
-	-
-	-
-	-

#### MECHANICAL CHARACTERISTICS

Mechanical life	20.000 cycles
Maximum number of auxiliary contacts that can be installed	2
Minimum cable size	4 mm <sup>2</sup>
Maximum cable size (rigid/flexible)	50 / 35 mm <sup>2</sup>
Maximum busbar width	-
Rated tightening torque	6 Nm
Pre-arrangement for lock in OFF position	Yes (ø6 mm max)
Height	94 mm
Width (mm)	108
Depth	50 mm
Weight (kg)	0.68
<b>DC RATED OPERATIONAL CURRENT (Ie)</b>	
DC-20A / DC-20B (220V DC)	100 A / 100 A
DC-20A / DC-20B (400V DC)	-
DC-20A / DC-20B (440V DC)	100 A / 100 A (2 poles in series for each polarity)
DC-20A / DC-20B (500V DC)	-
DC-21A / DC-21B (220V DC)	100 A / 100 A (2 poles in series for each polarity)
DC-21A / DC-21B (400V DC)	-
DC-21A / DC-21B (440V DC)	40 A / 40 A (2 poles in series for each polarity)
DC-21A / DC-21B (500V DC)	-
DC-22A / DC-22B (220V DC)	100 A / 100 A (2 poles in series for each polarity)
DC-22A / DC-22B (400V DC)	-
DC-22A / DC-22B (440V DC)	32 A / 32 A (2 poles in series for each polarity)
DC-22A / DC-22B (500V DC)	-
DC-23A / DC-23B (220V DC)	63 A / 63 A (2 poles in series for each polarity)
DC-23A / DC-23B (400V DC)	-
DC-23A / DC-23B (440V DC)	32 A / 32 A (2 poles in series for each polarity)
DC-23A / DC-23B (500V DC)	-

### DIMENSIONAL

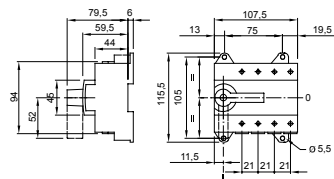



Product Data Sheet

GW97725

97 MSS Range

STANDARDS/APPROVALS

